

Abziehhülse Withdrawal Sleeves

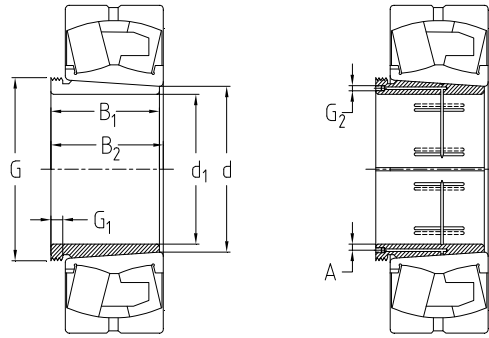

Abmessungen Dimensions						Gewicht Weight	Kurzzeichen Designation Abziehhülse Withdrawal Sleeves	Wellenmutter z. Demontage Locknut for disassembly	Hydraulik- mutter Hydraulic nuts
d ₁	d	B ₁	B ₂ ¹⁾	G	G ₁				
mm						kg			
35	40	29	32	M 45x1,5	6	0,09	AH 308	KM 9	-
		40	43	M 45x1,5	7	0,13	AH 2308	KM 9	-
40	45	31	34	M 50x1,5	6	0,12	AH 309	KM 10	RKP 50
		44	47	M 50x1,5	7	0,16	AH 2309	KM 10	RKP 50
45	50	35	38	M 55x2	7	0,13	AHX 310	KM 11	RKP 55
		50	53	M 55x2	9	0,19	AHX 2310	KM 11	RKP 55
50	55	37	40	M 60x2	7	0,16	AHX 311	KM 12	RKP 60
		54	57	M 60x2	10	0,26	AHX 2311	KM 12	RKP 60
55	60	40	43	M 65x2	8	0,19	AHX 312	KM 13	RKP 65
		58	61	M 65x2	11	0,30	AHX 2312	KM 13	RKP 65
60	65	42	45	M 70x2	8	0,23	AH 313 G	KM 14	RKP 70
		61	64	M 70x2	12	0,36	AH 2313 G	KM 14	RKP 70
65	70	43	47	M 75x2	8	0,25	AH 314 G	KM 15	RKP 75
		64	68	M 75x2	12	0,42	AHX 2314 G	KM 15	RKP 75
70	75	45	49	M 80x2	8	0,30	AH 315 G	KM 16	RKP 80
		68	72	M 80x2	12	0,48	AHX 2315 G	KM 16	RKP 80
75	80	48	52	M 90x2	8	0,37	AH 316	KM 18	RKP 90
		71	75	M 90x2	12	0,57	AHX 2316	KM 18	RKP 90
80	85	52	56	M 95x2	9	0,43	AHX 317	KM 19	RKP 95
		74	78	M 95x2	13	0,65	AHX 2317	KM 19	RKP 95

¹⁾ Breite vor dem Einpressen der Hülse in die Lagerbohrung

¹⁾ Width before the sleeves is pressed into the bearing bore

Abziehhülse Withdrawal Sleeves

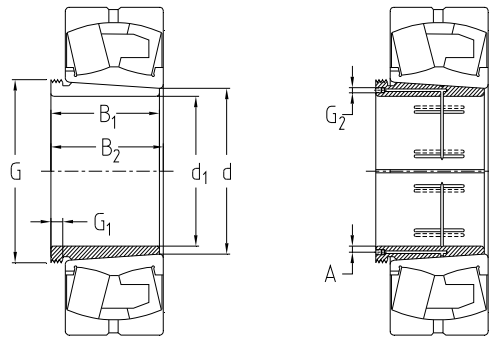

Abmessungen Dimensions						Gewicht Weight	Kurzzeichen Designation Abziehhülse Withdrawal Sleeves	Wellenmutter z. Demontage Locknut for disassembly	Hydraulik- mutter Hydraulic nuts
d ₁	d	B ₁	B ₂ ¹⁾	G	G ₁				
mm						kg			
85	90	53	57	M 100x2	9	0,46	AHX 318	KM 20	RKP 100
		79	83	M 100x2	14	0,76	AHX 2318	KM 20	RKP 100
		63	67	M 100x2	10	0,57	AHX 3218	KM 20	RKP 100
90	95	57	61	M 105x2	10	0,54	AHX 319	KM 21	RKP 105
		85	89	M 105x2	16	0,90	AHX 2319	KM 21	RKP 105
95	100	59	63	M 110x2	10	0,58	AHX 320	KM 22	RKP 110
		64	68	M 110x2	11	0,66	AHX 3120	KM 22	RKP 110
		73	77	M 110x2	11	0,76	AHX 3220	KM 22	RKP 110
		90	94	M 110x2	16	1,00	AHX 2320	KM 22	RKP 110
105	110	63	67	M 120x2	12	0,77	AHX 322	KM 24	RKP 120
		98	102	M 120x2	16	1,28	AHX 2322 G	KM 24	RKP 120
		68	72	M 120x2	11	0,76	AHX 3122	KM 24	RKP 120
		82	86	M 120x2	11	1,00	AHX 3222 G	KM 24	RKP 120
		82	91	M115x2	13	0,71	AH 24122	KM 23	RKP 115
115	120	105	109	M 130x2	17	1,53	AHX 2324 G	KM 26	RKP 130
		60	64	M 130x2	13	0,73	AHX 3024	KM 26	RKP 130
		75	79	M 130x2	12	0,94	AHX 3124	KM 26	RKP 130
		90	94	M 130x2	13	1,70	AHX 3224 G	KM 26	RKP 130
		73	82	M 125x2	13	0,70	AH 24024	KM 25	RKP 125
		93	102	M 130x2	13	1,00	AH 24124	KM 26	RKP 130
125	130	115	119	M 140x2	19	1,90	AHX 2326 G	KM 28	RKP 140
		67	71	M 140x2	14	0,91	AHX 3026	KM 28	RKP 140
		78	82	M 140x2	12	1,10	AHX 3126	KM 28	RKP 140

¹⁾ Breite vor dem Einpressen der Hülse in die Lagerbohrung

¹⁾ Width before the sleeves is pressed into the bearing bore

Abziehhülse Withdrawal Sleeves

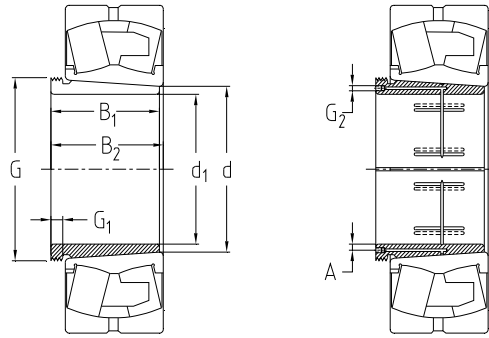

Abmessungen Dimensions						Gewicht Weight	Kurzzeichen Designation Abziehhülse Withdrawal Sleeves	Wellenmutter z. Demontage Locknut for disassembly	Hydraulik- mutter Hydraulic nuts
d ₁	d	B ₁	B ₂ ¹⁾	G	G ₁				
mm						kg			
125	130	98	102	M 140x2	15	1,50	AHX 3226 G	KM 28	RKP 140
		83	93	M 135x2	14	0,88	AH 24026	KM 27	RKP 135
		94	104	M 140x2	14	1,15	AH 24126	KM 28	RKP 140
135	140	125	130	M 150x2	20	2,25	AHX 2328 G	KM 30	RKP 150
		68	73	M 150x2	14	1,00	AHX 3028	KM 30	RKP 150
		83	88	M 150x2	14	1,30	AHX 3128	KM 30	RKP 150
		104	109	M 150x2	15	1,80	AHX 3228 G	KM 30	RKP 150
		83	93	M 145x2	14	0,95	AH 24028	KM 29	RKP 145
		99	109	M 150x2	14	1,30	AH 24128	KM 30	RKP 150
145	150	135	140	M 160x3	24	3,70	AHX 2330 G	KM 32	RKP 160
		72	77	M 160x3	15	1,15	AHX 3030	KM 32	RKP 160
		96	101	M 160x3	15	1,70	AHX 3130 G	KM 32	RKP 160
		114	119	M 160x3	17	2,10	AHX 3230 G	KM 32	RKP 160
		90	101	M 155x3	15	1,05	AH 24030	KM 31	RKP 155
		115	126	M 160x3	15	1,55	AH 24130	KM 32	RKP 160
150	160	140	146	M 170x3	24	4,30	AH 2332 G	KM 34	RKP 170
		77	82	M 170x3	16	2,05	AH 3032	KM 34	RKP 170
		103	108	M 170x3	16	3,00	AH 3132 G	KM 34	RKP 170
		124	130	M 170x3	20	3,70	AH 3232 G	KM 34	RKP 170
		95	106	M 170x3	15	2,30	AH 24032	KM 34	RKP 170
		124	135	M 170x3	15	3,00	AH 24132	KM 34	RKP 170
160	170	146	152	M 180x3	24	4,85	AH 2334 G	KM 36	RKP 180
		85	90	M 180x3	17	2,45	AH 3034	KM 36	RKP 180
		104	109	M 180x3	16	3,20	AH 3134 G	KM 36	RKP 180

¹⁾ Breite vor dem Einpressen der Hülse in die Lagerbohrung

¹⁾ Width before the sleeves is pressed into the bearing bore

Abziehhülse Withdrawal Sleeves

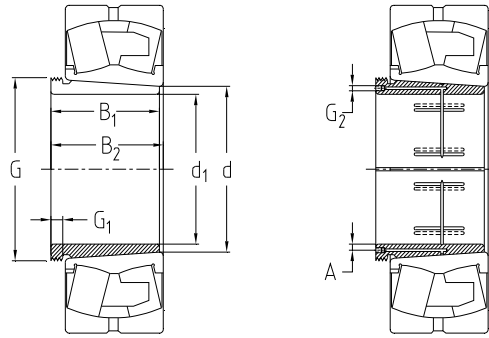

Abmessungen Dimensions						Gewicht Weight	Kurzzeichen Designation Abziehhülse Withdrawal Sleeves	Wellenmutter z. Demontage Locknut for disassembly	Hydraulik- mutter Hydraulic nuts
d ₁	d	B ₁	B ₂ ¹⁾	G	G ₁				
mm						kg			
160	170	134	140	M 180x3	24	4,35	AH 3234 G	KM 36	RKP 180
		106	117	M 180x3	16	2,70	AH 24034	KM 36	RKP 180
		125	136	M 180x3	16	3,25	AH 23134	KM 36	RKP 180
170	180	105	110	M 190x3	17	3,40	AH 2236 G	KM 38	RKP 190
		154	160	M 190x3	26	5,50	AH 2336 G	KM 38	RKP 190
		92	98	M 190x3	17	2,80	AH 3036	KM 38	RKP 190
		116	122	M 190x3	19	3,90	AH 3136 G	KM 38	RKP 190
		140	146	M 190x3	24	4,85	AH 3236 G	KM 38	RKP 190
		116	127	M 190x3	16	3,20	AH 24036	KM 38	RKP 190
		134	145	M 190x3	16	3,75	AH 24136	KM 38	RKP 190
180	190	112	117	M 200x3	18	3,90	AH 2238 G	KM 40	RKP 200
		160	167	M 200x3	26	6,10	AH 2338 G	KM 40	RKP 200
		96	102	M 200x3	18	3,30	AH 3038 G	KM 40	RKP 200
		125	131	M 200x3	20	4,50	AH 3138 G	KM 40	RKP 200
		145	152	M 200x3	25	5,40	AH 3238 G	KM 40	RKP 200
		118	131	M 200x3	18	3,55	AH 24038	KM 40	RKP 200
		146	159	M 200x3	18	4,45	AH 24138	KM 40	RKP 200
190	200	118	123	Tr 220x4	19	4,70	AH 2240	HM 44 T	RKP 220
		170	177	Tr 220x4	30	7,60	AH 2340	HM 44 T	RKP 220
		102	108	Tr 210x4	19	3,70	AH 3040 G	HM 42 T	RKP 210
		134	140	Tr 220x4	21	5,65	AH 3140	HM 44 T	RKP 220
		153	160	Tr 220x4	25	6,60	AH 3240	HM 44 T	RKP 220
		127	140	Tr 210x4	18	4,00	AH 24040	HM 42 T	RKP 210
		158	171	Tr 210x4	18	5,05	AH 24140	HM 42 T	RKP 210

¹⁾ Breite vor dem Einpressen der Hülse in die Lagerbohrung

¹⁾ Width before the sleeves is pressed into the bearing bore

Abziehhülse Withdrawal Sleeves

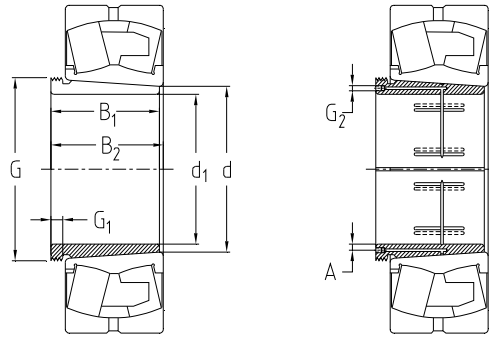

Abmessungen Dimensions						Gewicht Weight	Kurzzeichen Designation Abziehhülse Withdrawal Sleeves	Wellenmutter z. Demontage Locknut for disassembly	Hydraulik- mutter Hydraulic nuts
d ₁	d	B ₁	B ₂ ¹⁾	G	G ₁				
mm						kg			
200	220	181	189	Tr 240x4	30	13,50	AOH 2344	HM 48 T	RKP 240
		111	117	Tr 230x4	20	7,30	AOH 3044 G	HM 46 T	RKP 230
		145	151	Tr 240x4	23	9,30	AOH 3144	HM 48 T	RKP 240
		130	136	Tr 240x4	20	9,40	AOH 2244	HM 48 T	RKP 240
		138	152	Tr 230x4	20	8,20	AOH 24044	HM 46 T	RKP 230
		170	184	Tr 230x4	20	10,00	AOH 24144	HM 46 T	RKP 230
220	240	189	197	Tr 260x4	30	14,0	AOH 2348	HM 52 T	RKP 260
		116	123	Tr 260x4	21	7,95	AOH 3048	HM 52 T	RKP 260
		154	161	Tr 260x4	25	12,0	AOH 3148	HM 52 T	RKP 260
		144	150	Tr 260x4	21	11,5	AOH 2248	HM 52 T	RKP 260
		138	153	Tr 260x4	20	8,05	AOH 24048	HM 50 T	RKP 250
		180	195	Tr 260x4	20	11,5	AOH 24148	HM 52 T	RKP 260
240	260	155	161	Tr 280x4	23	13,5	AOH 2252 G	HM 56 T	RKP 280
		205	213	Tr 280x4	30	19,0	AOH 2352 G	HM 56 T	RKP 280
		128	135	Tr 280x4	23	9,6	AOH 3052	HM 56 T	RKP 280
		172	179	Tr 280x4	26	15,5	AOH 3152 G	HM 56 T	RKP 280
		162	178	Tr 280x4	22	12,5	AOH 24052 G	HM 56 T	RKP 280
		202	218	Tr 280x4	22	14,0	AOH 24152	HM 56 T	RKP 280
260	280	155	163	Tr 300x4	24	14,8	AOH 2256 G	HM 3160	RKP 300
		212	220	Tr 300x4	30	21,5	AOH 2356 G	HM 3160	RKP 300
		131	139	Tr 300x4	24	11,0	AOH 3056	HM 3060	RKP 300
		175	183	Tr 300x4	28	17,0	AOH 3156 G	HM 3160	RKP 300
		162	179	Tr 300x4	22	13,5	AOH 24056 G	HM 3160	RKP 300
		202	219	Tr 300x4	22	15,0	AOH 24156	HM 3160	RKP 300

¹⁾ Breite vor dem Einpressen der Hülse in die Lagerbohrung

¹⁾ Width before the sleeves is pressed into the bearing bore

Abziehhülse Withdrawal Sleeves

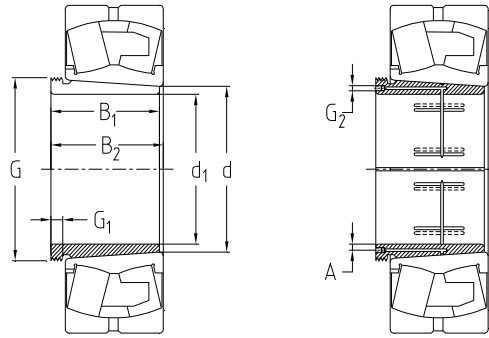

Abmessungen Dimensions						Gewicht Weight	Kurzzeichen Designation Abziehhülse Withdrawal Sleeves	Wellenmutter z. Demontage Locknut for disassembly	Hydraulik- mutter Hydraulic nuts
d ₁	d	B ₁	B ₂ ¹⁾	G	G ₁				
mm						kg			
280	300	170	178	Tr 320x5	26	17,5	AOH 2260 G	HM 3164	RKP 320
		145	153	Tr 320x5	26	13,0	AOH 3060	HM 3064	RKP 320
		192	200	Tr 320x5	30	20,5	AOH 3160 G	HM 3164	RKP 320
		228	236	Tr 320x5	34	23,5	AOH 3260 G	HM 3164	RKP 320
		184	202	Tr 320x5	24	17,0	AOH 24060 G	HM 3164	RKP 320
		224	242	Tr 320x5	24	18,5	AOH 24160	HM 3164	RKP 320
300	320	180	190	Tr 340x5	27	20,0	AOH 2264 G	HM 3168	RKP 340
		149	157	Tr 340x5	27	16,5	AOH 3064 G	HM 3068	RKP 340
		209	217	Tr 340x5	31	24,5	AOH 3164 G	HM 3168	RKP 340
		246	254	Tr 340x5	36	27,5	AOH 3264 G	HM 3168	RKP 340
		184	202	Tr 340x5	24	18,0	AOH 24064 G	HM 3168	RKP 340
		242	260	Tr 340x5	24	20,5	AOH 24164	HM 3168	RKP 340
320	340	162	171	Tr 360x5	28	19,0	AOH 3068 G	HM 3072	RKP 360
		225	234	Tr 360x5	33	28,0	AOH 3168 G	HM 3172	RKP 360
		264	273	Tr 360x5	38	32,0	AOH 3268 G	HM 3172	RKP 360
		206	225	Tr 360x5	26	18,0	AOH 24068	HM 3172	RKP 360
		269	288	Tr 360x5	26	25,5	AOH 24168	HM 3172	RKP 360
340	360	167	176	Tr 380x5	30	21,0	AOH 3072 G	HM 3076	RKP 380
		229	238	Tr 380x5	35	30,5	AOH 3172 G	HM 3176	RKP 380
		274	283	Tr 380x5	40	35,5	AOH 3272 G	HM 3176	RKP 380
		206	226	Tr 380x5	26	20,0	AOH 24072	HM 3176	RKP 380
		269	289	Tr 380x5	26	26,0	AOH 24172	HM 3176	RKP 380
360	380	170	180	Tr 400x5	31	23,0	AOH 3076 G	HM 3080	RKP 400
		232	242	Tr 400x5	36	33,0	AOH 3176 G	HM 3180	RKP 400

¹⁾ Breite vor dem Einpressen der Hülse in die Lagerbohrung

¹⁾ Width before the sleeves is pressed into the bearing bore

Abziehhülse Withdrawal Sleeves

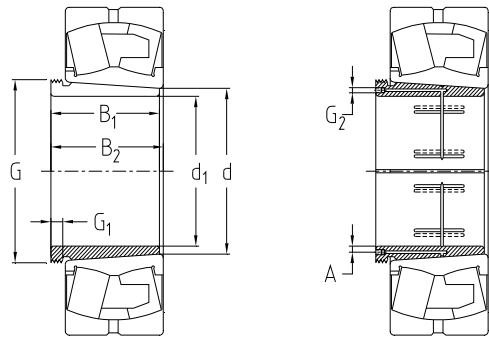

Abmessungen Dimensions						Gewicht Weight	Kurzzeichen Designation Abziehhülse Withdrawal Sleeves	Wellenmutter z. Demontage Locknut for disassembly	Hydraulik- mutter Hydraulic nuts
d ₁	d	B ₁	B ₂ ¹⁾	G	G ₁				
mm						kg			
360	380	284	294	Tr 400x5	42	42,0	AOH 3276 G	HM 3180	RKP 400
		208	228	Tr 400x5	28	23,0	AOH 24076	HM 3180	RKP 400
		271	291	Tr 400x5	28	31,0	AOH 24176	HM 3180	RKP 400
380	400	183	193	Tr 420x5	33	26,0	AOH 3080 G	HM 3184	RKP 420
		240	250	Tr 420x5	38	36,0	AOH 3180 G	HM 3184	RKP 420
		302	312	Tr 420x5	44	48,0	AOH 3280 G	HM 3184	RKP 420
		228	248	Tr 420x5	28	27,0	AOH 24080	HM 3184	RKP 420
		278	298	Tr 420x5	28	35,0	AOH 24180	HM 3184	RKP 420
400	420	186	196	Tr 440x5	34	28,0	AOH 3084 G	HM 3088	RKP 440
		266	276	Tr 440x5	40	43,0	AOH 3184 G	HM 3188	RKP 440
		321	331	Tr 440x5	46	54,5	AOH 3284 G	HM 3188	RKP 440
		230	252	Tr 440x5	30	29,0	AOH 24084	HM 3188	RKP 440
		310	332	Tr 440x5	30	39,0	AOH 24184	HM 3188	RKP 440
420	440	194	205	Tr 460x5	35	30,8	AOH 3088 G	HM 3092	RKP 460
		270	281	Tr 460x5	42	46,0	AOH 3188 G	HM 3192	RKP 460
		330	341	Tr 460x5	48	59,0	AOH 3288 G	HM 3192	RKP 460
		242	264	Tr 460x5	30	32,0	AOH 24088	HM 3192	RKP 460
		310	332	Tr 460x5	30	45,5	AOH 24188	HM 3192	RKP 460
440	460	202	213	Tr 480x5	37	33,8	AOH 3092 G	HM 3096	RKP 480
		285	296	Tr 480x5	43	51,5	AOH 3192 G	HM 3196	RKP 480
		349	360	Tr 480x5	50	66,5	AOH 3292 G	HM 3196	RKP 480
		250	273	Tr 480x5	32	34,7	AOH 24092	HM 3196	RKP 480
		332	355	Tr 480x5	32	50,0	AOH 24192	HM 3196	RKP 480

¹⁾ Breite vor dem Einpressen der Hülse in die Lagerbohrung

¹⁾ Width before the sleeves is pressed into the bearing bore

Abziehhülse Withdrawal Sleeves

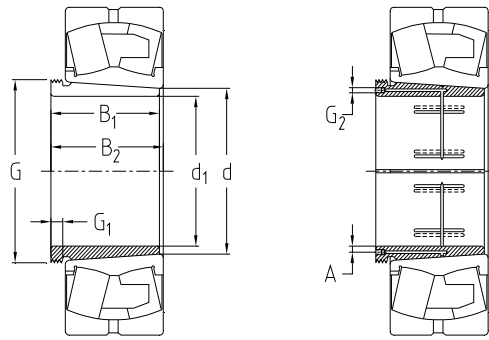

Abmessungen Dimensions						Gewicht Weight	Kurzzeichen Designation Abziehhülse Withdrawal Sleeves	Wellenmutter z. Demontage Locknut for disassembly	Hydraulik- mutter Hydraulic nuts
d ₁	d	B ₁	B ₂ ¹⁾	G	G ₁				
mm						kg			
460	480	205	217	Tr 500x5	38	36,0	AOH 3096 G	HM 30/500	RKP 500
		295	307	Tr 500x5	45	56,0	AOH 3196 G	HM 31/500	RKP 500
		364	376	Tr 500x5	52	73,5	AOH 3296 G	HM 31/500	RKP 500
		250	273	Tr 500x5	32	36,6	AOH 24096	HM 31/500	RKP 500
		340	363	Tr 500x5	32	51,5	AOH 24196	HM 31/500	RKP 500
480	500	209	221	Tr 530x6	40	41,0	AOHX 30/500 G	HM 30/530	RKP 530
		313	325	Tr 530x6	47	66,5	AOHX 31/500 G	HM 31/530	RKP 530
		393	405	Tr 530x6	54	89,5	AOHX 32/500 G	HM 31/530	RKP 530
		253	276	Tr 530x6	35	41,7	AOH 240/500	HM 31/530	RKP 530
		360	383	Tr 530x6	35	57,0	AOH 241/500	HM 31/530	RKP 530
500	530	230	242	Tr 560x6	45	63,5	AOH 30/530	HM 30/560	RKP 560
		325	337	Tr 560x6	53	94,5	AOH 31/530	HM 31/560	RKP 560
		412	424	Tr 560x6	57	127,0	AOH 32/530 G	HM 31/560	RKP 560
		285	309	Tr 560x6	35	69,5	AOH 240/530 G	HM 31/560	RKP 560
		370	394	Tr 560x6	35	91,5	AOH 241/530 G	HM 31/560	RKP 560
530	560	240	252	Tr 600x6	45	73,5	AOHX 30/560	HM 30/600	RKP 600
		335	347	Tr 600x6	55	108,0	AOH 31/560	HM 31/600	RKP 600
		422	434	Tr 600x6	57	143,0	AOHX 32/560	HM 31/600	RKP 600
		296	320	Tr 600x6	38	79,5	AOH 240/560 G	HM 31/600	RKP 600
		393	417	Tr 600x6	38	107,0	AOH 241/560 G	HM 31/600	RKP 600
570	600	245	259	Tr 630x6	45	77,0	AOHX 30/600	HM 30/630	RKP 630
		355	369	Tr 630x6	55	120,0	AOHX 31/600	HM 31/630	RKP 630
		445	459	Tr 630x6	57	159,0	AOHX 32/600 G	HM 31/630	RKP 630
		310	336	Tr 630x6	38	86,5	AOHX 240/600	HM 31/630	RKP 630
		413	439	Tr 630x6	38	118,0	AOHX 241/600	HM 31/630	RKP 630

¹⁾ Breite vor dem Einpressen der Hülse in die Lagerbohrung

¹⁾ Width before the sleeves is pressed into the bearing bore

Abziehhülse Withdrawal Sleeves

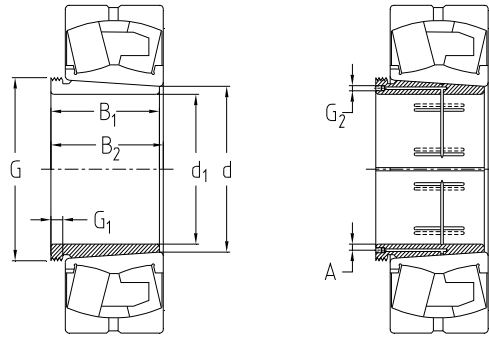

Abmessungen Dimensions						Gewicht Weight	Kurzzeichen Designation Abziehhülse Withdrawal Sleeves	Wellenmutter z. Demontage Locknut for disassembly	Hydraulik- mutter Hydraulic nuts
d ₁	d	B ₁	B ₂ ¹⁾	G	G ₁				
mm						kg			
600	630	258	272	Tr 670x6	46	89,5	AOH 30/630	HM 30/670	RKP 670
		375	389	Tr 670x6	60	140,0	AOH 31/630	HM 31/670	RKP 670
		475	489	Tr 670x6	63	188,0	AOH 32/630 G	HM 31/670	RKP 670
		330	356	Tr 670x6	40	101,0	AOH 240/630 G	HM 31/670	RKP 670
		440	466	Tr 670x6	40	136,0	AOH 241/630 G	HM 31/670	RKP 670
630	670	280	294	Tr 710x7	50	127,0	AOH 30/670	HM 30/710	RKP 710
		395	409	Tr 710x7	59	189,0	AOHX 31/670	HM 31/710	RKP 710
		500	514	Tr 710x7	62	252,0	AOH 32/670 G	HM 31/710	RKP 710
		348	374	Tr 710x7	40	140,0	AOH 240/670 G	HM 31/710	RKP 710
		452	478	Tr 710x7	40	185,0	AOH 241/670 G	HM 31/710	RKP 710
670	710	286	302	Tr 750x7	50	138,0	AOHX 30/710	HM 30/750	RKP 750
		405	421	Tr 750x7	60	207,0	AOHX 31/710	HM 31/750	RKP 750
		515	531	Tr 750x7	65	278,0	AOH 32/710 G	HM 31/750	RKP 750
		360	386	Tr 750x7	45	155,0	AOH 240/710 G	HM 31/750	RKP 750
		483	509	Tr 750x7	45	212,0	AOH 241/710 G	HM 31/750	RKP 750
710	750	300	316	Tr 800x7	50	159	AOH 30/750	HM 30/800	RKP 800
		425	441	Tr 800x7	60	238	AOH 31/750	HM 31/800	RKP 800
		540	556	Tr 800x7	65	320	AOH 32/750	HM 31/800	RKP 800
		380	408	Tr 800x7	45	178	AOH 240/750 G	HM 31/800	RKP 800
		520	548	Tr 800x7	45	248	AOH 241/750 G	HM 31/800	RKP 800
750	800	307	326	Tr 850x7	50	204	AOH 30/800	HM 30/850	RKP 850
		438	456	Tr 850x7	63	305	AOH 31/800	HM 31/850	RKP 850
		550	568	Tr 850x7	67	401	AOH 32/800	HM 31/850	RKP 850
		395	423	Tr 850x7	50	237	AOH 240/800 G	HM 31/850	RKP 850
		525	553	Tr 850x7	50	318	AOH 241/800 G	HM 31/850	RKP 850

¹⁾ Breite vor dem Einpressen der Hülse in die Lagerbohrung

¹⁾ Width before the sleeves is pressed into the bearing bore

Abziehhülse Withdrawal Sleeves

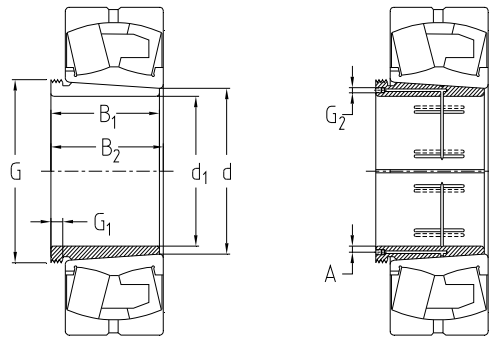

Abmessungen Dimensions						Gewicht Weight	Kurzzeichen Designation Abziehhülse Withdrawal Sleeves	Wellenmutter z. Demontage Locknut for disassembly	Hydraulik- mutter Hydraulic nuts
d ₁	d	B ₁	B ₂ ¹⁾	G	G ₁				
mm						kg			
800	850	325	343	Tr 900x7	53	230	AOH 30/850	HM 30/900	RKP 900
		462	480	Tr 900x7	62	345	AOH 31/850	HM 31/900	RKP 900
		585	603	Tr 900x7	70	461	AOH 32/850	HM 31/900	RKP 900
		415	445	Tr 900x7	50	265	AOH 240/850 G	HM 31/900	RKP 900
		560	600	Tr 900x7	60	368	AOH 241/850	HM 31/900	RKP 900
850	900	335	355	Tr 950x8	55	253	AOH 30/900	HM 30/950	RKP 950
		475	495	Tr 950x8	63	379	AOH 31/900	HM 31/950	RKP 950
		585	605	Tr 950x8	70	489	AOH 32/900	HM 31/950	RKP 950
		430	475	Tr 950x8	55	296	AOH 240/900	HM 31/950	RKP 950
		575	620	Tr 950x8	60	402	AOH 241/900	HM 31/950	RKP 950
900	950	355	375	Tr 1000x8	55	285	AOH 30/950	HM 30/1000	RKP 1000
		500	520	Tr 1000x8	62	426	AOH 31/950	HM 31/1000	RKP 1000
		600	620	Tr 1000x8	70	533	AOH 32/950	HM 31/1000	RKP 1000
		467	512	Tr 1000x8	55	340	AOH 240/950	HM 31/1000	RKP 1000
		605	650	Tr 1000x8	60	449	AOH 241/950	HM 31/1000	RKP 1000
950	1000	365	387	Tr 1060x8	57	318	AOH 30/1000	HM 30/1060	RKP 1060
		525	547	Tr 1060x8	63	485	AOH 31/1000	HM 30/1060	RKP 1060
		630	652	Tr 1060x8	70	608	AOH 32/1000	HM 30/1060	RKP 1060
		469	519	Tr 1060x8	57	369	AOH 240/1000	HM 30/1060	RKP 1060
		645	695	Tr 1060x8	65	519	AOH 241/1000	HM 30/1060	RKP 1060
1000	1060	385	407	Tr 1120x8	60	406	AOH 30/1060	HM 30/1120	RKP 1120
		540	562	Tr 1120x8	65	599	AOH 31/1060	HM 30/1120	RKP 1120
1000	1060	498	548	Tr 1120x8	60	479	AOH 240/1060	HM 30/1120	RKP 1120
		665	715	Tr 1120x8	65	652	AOH 241/1060	HM 30/1120	RKP 1120

¹⁾ Breite vor dem Einpressen der Hülse in die Lagerbohrung

¹⁾ Width before the sleeves is pressed into the bearing bore